

IDENTIV ICPAM 4.0.0(0.3.16) Release Notes

Copyright© 2021, Identiv Inc. Last updated on March 17th, 2021.

Overview

An active SSA agreement is required to receive this update. Contact your local Regional Sales Representative or customerservice@identiv.com for assistance.

The ICPAM 4.0.0(0.3.16) release includes:

- Support for Amazon JAVA Runtime Environment 8
- Support for 64-bit Architecture
- Support for Apache Tomcat v9.0

This document also summarizes the [System Requirements](#).

IMPORTANT UPGRADE & INSTALLATION NOTES!!

Before upgrading to ICPAM 4.0.0(0.3.16):

- **Create a VM snapshot of the current ICPAM production environment.**
- **Upgrading to ICPAM 4.0.0(0.3.16) is a TWO step upgrade process:**
 - **First upgrade to ICPAM 3.3.3(0.3.2) →**
 - **Then upgrade from ICPAM 3.3.3(0.3.2) to ICPAM 4.0.0(0.3.16)**
- **It is **HIGHLY** recommended to prune the events/alarms logs to:**
 - **100,000 Events or Less for Systems with 16GB of RAM**
 - **400,000 Events or Less for Systems with 32GB of RAM**

Failure to trim event logs to the recommendation above will lead to significantly longer installation periods and extended downtime for the ICPAM Server.

- **Virtual Credential Templates are NOT supported in ICPAM 4.0. Please refer to the Enabling Unified Credential Template section below for more information.**
- **ICPAM 4.0.0 CANNOT be downgraded to ICPAM 3.3.X using the standard downgrade process.**

System Requirements

Before installing ICPAM, make sure your server or client computer meets the following requirements.

Hardware Requirements

In summary, the hardware minimum requirements for a computer performing the role of a Server, Client, or Workstation are the same as for the ICPAM 3.3.1 release. Here are the detailed hardware requirements for each role.

For the ICPAM Server (Virtualized in VMWare v5.1 or v6.0):

Computer role:	Minimum Requirements
ICPAM (Server)	<ul style="list-style-type: none"> • 4 Virtual Processors • 16GB RAM • 500GB HDD • 1 Ethernet port
ICPAM (Workstation, Client)	<ul style="list-style-type: none"> • Modern Intel and AMD multi-core processor • 4GB RAM or More • 250GB HDD • Mouse • Keyboard • Monitor • Ethernet port

Operating System Requirements

The following table shows supported versions of Windows by ICPAM 4.0.0(0.3.16)

Computer role:	Versions of Windows supported by ICPAM 4.0.0(0.3.16)
ICPAM (Workstation, Client)	<ul style="list-style-type: none"> • Windows 8.1 • Windows 10
ICPAM Client	<ul style="list-style-type: none"> • JRE 1.8 (REQUIRED)

Link to downloadable Amazon JRE 8 for Windows client machine is available in the ICPAM Server Configuration page under "Downloads" section on the .

Connected PAM Server Administration

Monitoring	Setup	Commands	Launch Identiv Client	Downloads
Downloads				
<ul style="list-style-type: none"> • JRE 1.8 (Windows) • Identiv CPAM Client (JRE required) 				

ICPAM Software Requirements

For the ICPAM Server:

- ICPAM 3.3.3(0.3.2)

ICPAM Supported Upgrade Paths:

ICPAM 3.3.0(0.3.7) → ICPAM 3.3.3(0.3.2) → ICPAM 4.0.0(0.3.16)

ICPAM 3.3.1(0.3.2)→ ICPAM 3.3.3(0.3.2) → ICPAM 4.0.0(0.3.16)

ICPAM 3.3.2(0.3.2)→ ICPAM 3.3.3(0.3.2) → ICPAM 4.0.0(0.3.16)

Enable Unified Credential Template (Supported in ICPAM 3.1 and later)

Before upgrading to ICPAM 4.0, please ensure that Unified Credential Templates are enabled:

1. In **System Configuration**, select the *Advanced Settings* option
2. Make sure that the “Enable Virtual Credential Templates Module” option is **UNCHECKED**

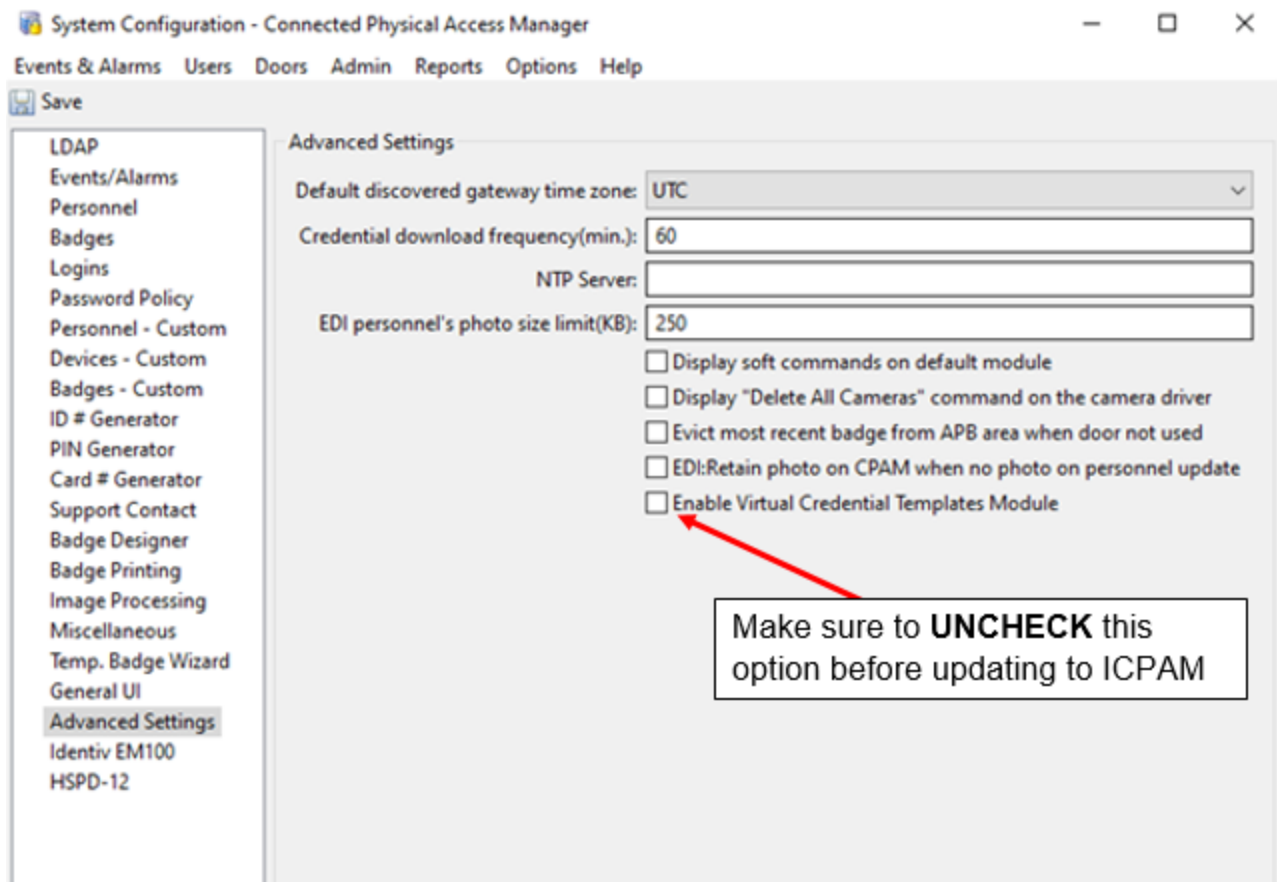

Firmware Recommendations

Hardware Type	Firmware	SNIB3 Version
Cisco Gateway (CIAC-GW-K9)	1.5.3	N/A
EM-100	3.8.0-103	N/A
Mx-1, Mx-4 & Mx-8	7.6.42	2.05.1032

Compatible Builds of Integrations or Optional Components

The following table shows the compatible builds of integrations or optional components for ICPAM:

Component:	Compatible build for ICPAM 4.0.0(0.3.16)
Cisco VSOM	7.11.1

New Features and Enhancements

This section summarizes the new features and enhancements introduced in ICPAM 4.0 release:

Support for Open Source Amazon Java Runtime Environment 8

Link to downloadable Amazon JRE 8 for Windows client machine is available in the ICPAM Server Configuration page under "Downloads" section on the .

Connected PAM Server Administration

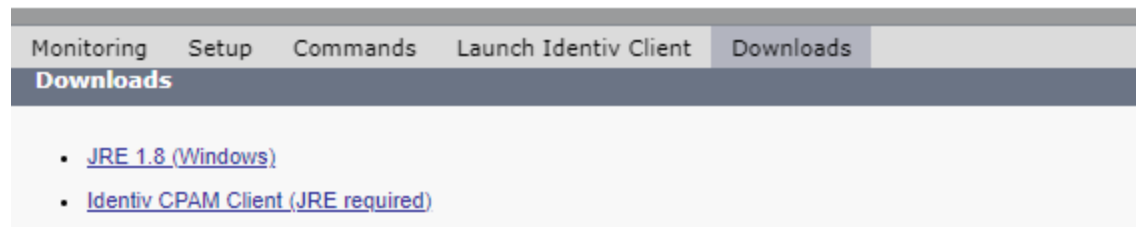

Monitoring Setup Commands Launch Identiv Client Downloads

Downloads

- [JRE 1.8 \(Windows\)](#)
- [Identiv CPAM Client \(JRE required\)](#)

Support for 64-bit Architecture

Improvements and Fixes

Reference ID	Summary
FP-214	Support for JAVA 8
FP-214	Support for 64-bit
FP-214	Support for Larger Map file sizes (up to 6MB)
FP-214	Support for Apache Tomcat v9.0

Known Limitations

Reference ID	Summary
FP-587	Failed to disable EM-100 device from client
FP-655	Quick launch module displays duplicated devices
FP-703	Forced logout cmd from workstation module does not execute
FP-711	No HA license displayed during initial setup with valid licenses
FP-725	In Map Editor Mode devices not displaying correctly when applied to layer 5 or deeper on New Map
FP-730	When enrolling a new badge, enrollBadge API doesn't display Role during creation
FP-779	Map viewer not displaying highlighted device when execute "Show in Maps" options in Hardware Tree
FP-822	In Map Editor Mode location tab is not displaying correctly
FP-861	Quick launch UI does not show text in buttons